



**ADJUSTABLE ARM KIT
(P/N 861 776 700)**

⚠ WARNING

For safety reasons, this kit must be installed by an authorized Ski-Doo® snowmobile dealer. Should removal of a locking device (e.g. lock tabs, self-locking fasteners, etc.) be required when undergoing disassembly/assembly, always replace with a new one. This instruction sheet should be given to the purchaser. This kit is designed for specific applicable models only. It is not recommended for units other than those for which it was sold.

NOTE: Installation time is approximately 1.0 hour.

PARTS TO BE INSTALLED

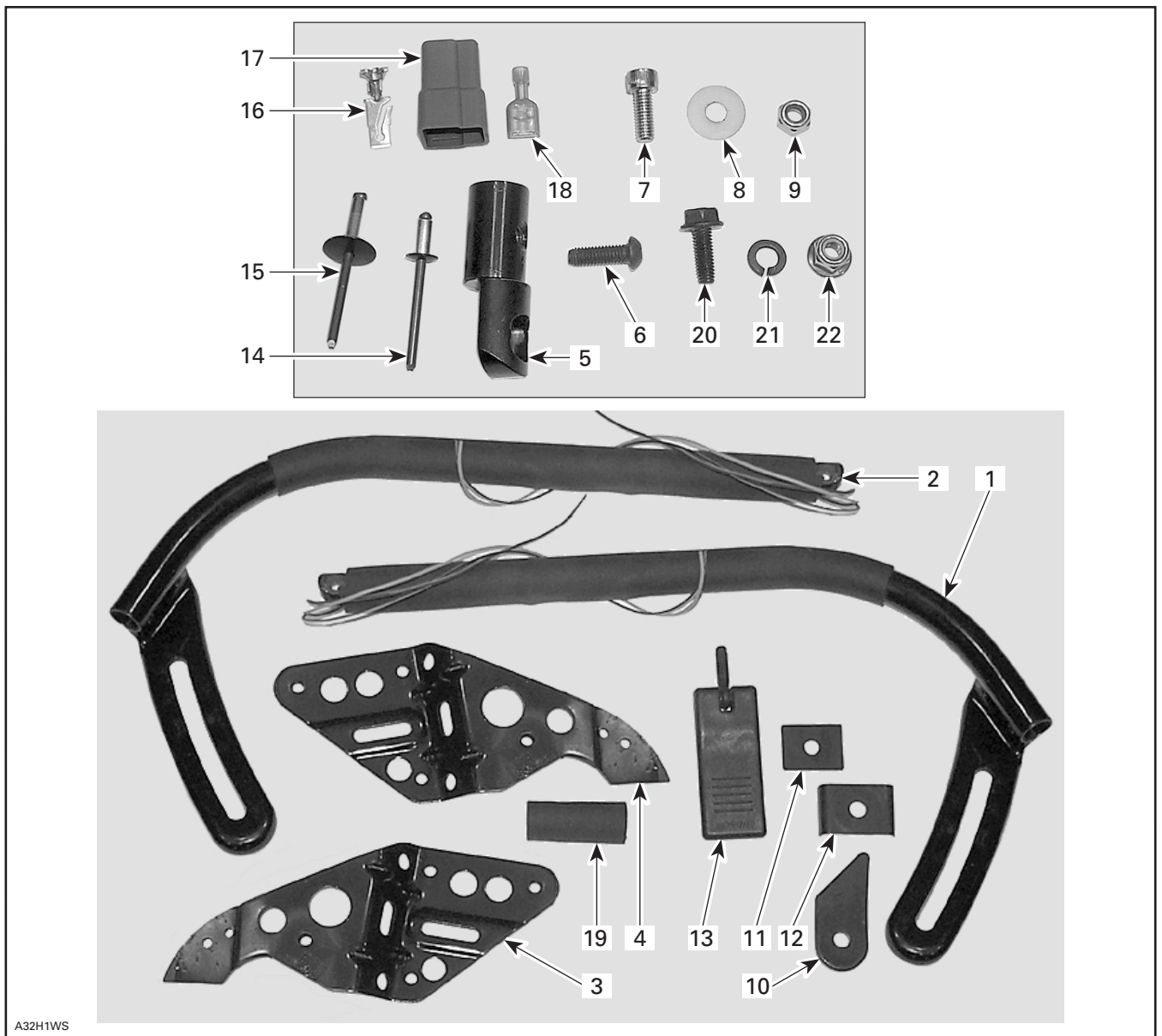

A32H1WS

1. Right Hand Arm Assembly
2. Left Hand Arm Assembly
3. Right Hand Retaining Plate
4. Left Hand Retaining Plate
5. Pivot (2)
6. Hexagonal Socket Head Bolt M6 x 18 (2)
7. Hexagonal Socket Head Bolt M6 x 16 (2)
8. Plastic Flat Washer M6 (2)
9. Hexagonal Elastic Nut (2)
10. Spacer Block (2)
11. Outer Spacer (2)

12. Guide (2)
13. Lever Assembly (2)
14. Black Rivet 3/16 in (4)
15. Black Rivet 3/16 in (4)
16. Male Terminal (3)
17. Male Housing
18. Female Terminal (3)
19. Handle Grip
20. Self-Tapping Flanged Hexagonal Screw (6)
21. Helicoid Lock Washer M6 (6)
22. Elastic Flanged Nut M6 (2)

PROCEDURE

Remove seat and rear mouldings then disconnect electrical housings. See *Ski-Doo Shop Manual*, for proper procedure.

Using a M5 (3/16 in) drill, drill rivets securing hand protectors. Keep protectors for further reinstallation.



Using a M5 (3/16 in) drill, drill rivets securing fixation plates.

Remove caps and unscrew fixation plates. Discard bolts, nuts, bushings and washers.

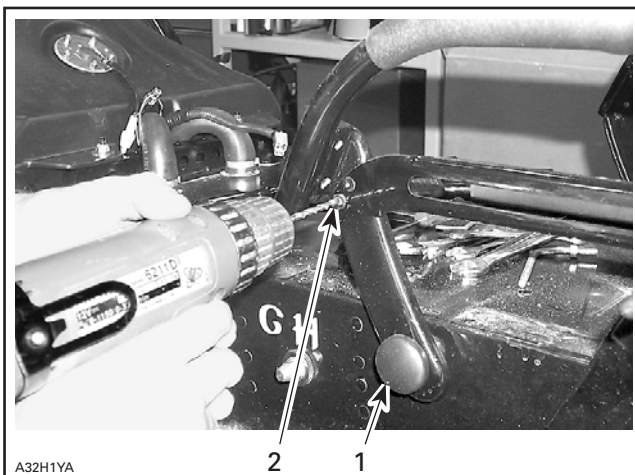

1. Remove cap and unscrew bolt
2. Drill rivets

Gently pull arm toward front to free it from luggage rack.

Dismount rear suspension and drill frame through suspension plate welded nuts as shown on next drawing.

CAUTION: Take care to avoid damaging threads while drilling.

Use a M6 drill to chamfer chassis hole.

Fixation plate is secured with screws **no. 20** and the lock washers **no. 21**.

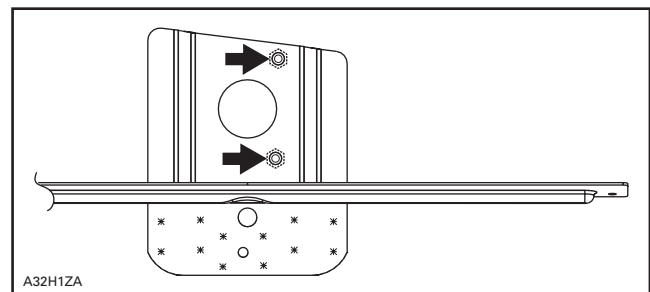

Left Arm Replacement

Cut connector and remove harness from upright. Do not remove sheath.

On frame side, install fixation plate **no. 4** with two screws **no. 20** and two lock washers **no. 21** in holes previously drilled.

Using rack reinforcement holes as a template, drill a 5 mm (3/16 in) hole and install left hand fixation plate **no. 4** with two rivets **no. 14** on luggage rack reinforcement.

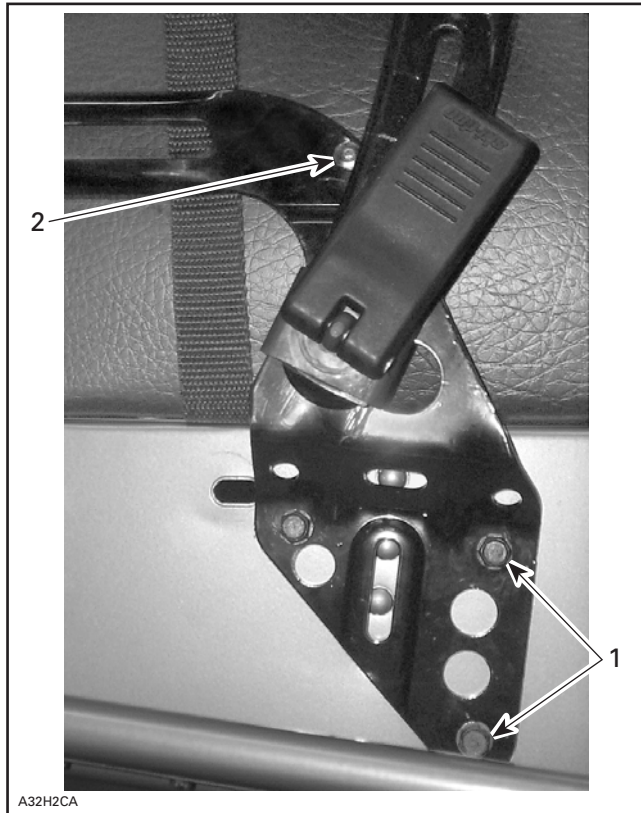

1. Secure plate using these holes
2. Drill and rivet

With a punch, mark a hole on center of tubing at 14.5 mm (9/16 in) from end of luggage rack tubing (inside rack).

Drill tubing with a M6 (7/32 in) drill.

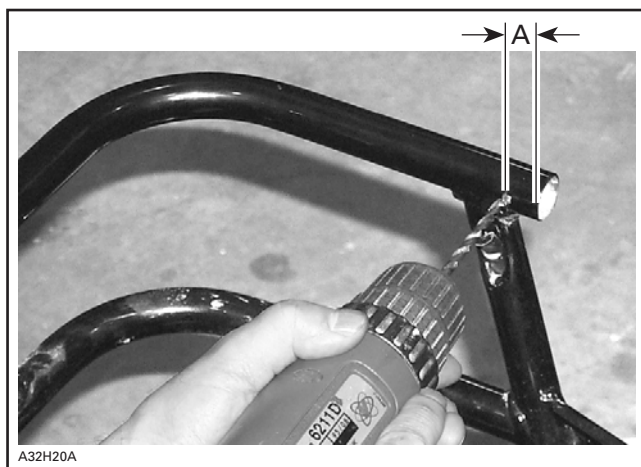

A. 14.5 mm (9/16 in)

Insert pivot **no. 5** on left hand arm assembly **no. 2** and secure with a hexagonal socket head bolt **no. 7** and hexagonal elastic nut **no. 9**. Insert plastic flat washer **no. 8** between pivot and arm.

Insert wires in upright's upper sheath and pull out from lower hole of upright. Make sure lower sheath is around wires.

Insert pivot **no. 5** in tubing and secure it with hexagonal socket head bolt **no. 6**.

NOTE: The soldering of the upright may interfere with pivot. There may be necessary to grind the interior of the tubing to manage room to the pivot.

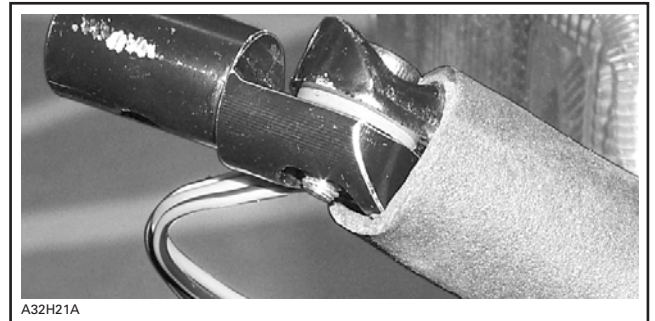

Unsheathe wires and clamp male terminals **no. 16**.

NOTE: To ensure a good electrical contact and a good mechanical resistance, threads can be soldered on terminals.

Insert wires into male connector **no. 17** according to the following photo.

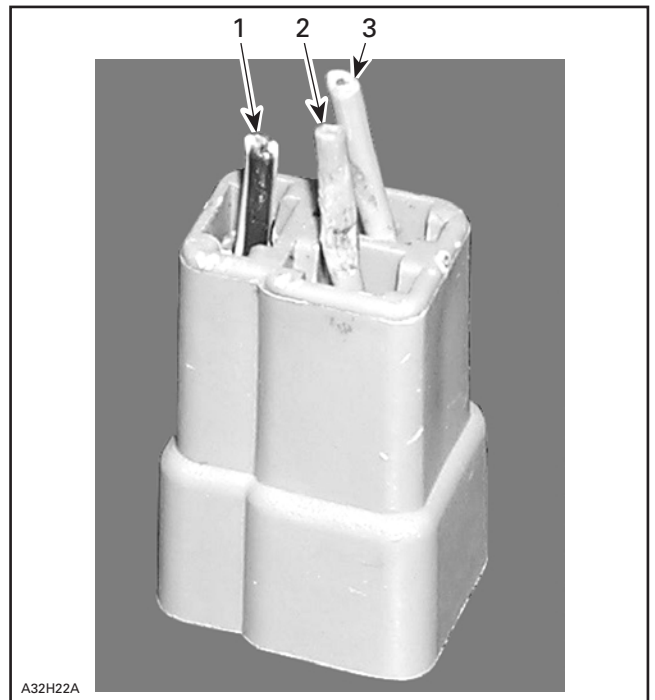

1. YELLOW/BLACK
2. ORANGE/VIOLET
3. ORANGE

Adjust and secure arm using lever assembly **no. 13**, guide **no. 12**, outer spacer **no. 11** and spacer block **no. 10**.

Right Arm Replacement

Unscrew cover of rear heating grip switch. Cut wires leading to the handle grip long enough to be able to identify wire colors at reassembly and loosen set screw to free switch from handle.

NOTE: Handle may be replaced with grip sheath **no. 19** if necessary.

Insert switch in right hand arm assembly **no. 1**.

On frame side, install fixation plate with two screws **no. 20**, and two lock washers **no. 21** in holes previously drilled.

Install right hand fixation plate **no. 3** with rivets **no. 14** on luggage rack reinforcement.

With a punch, mark a hole on center of tubing at 14.5 mm (9/16 in) from end of luggage rack tubing (inside rack).

Drill tubing with a M6 (7/32 in) drill.

Insert pivot **no. 5** on right hand arm assembly **no. 1** and secure with a hexagonal socket head bolt **no. 7** and hexagonal elastic nut **no. 9**. Insert plastic flat washer **no. 8** between pivot and arm.

Insert pivot **no. 5** in tubing and secure it with hexagonal socket head bolt **no. 6**.

NOTE: The soldering of the upright may interfere with pivot. There may be necessary to grind the interior of the tubing to manage room to the pivot.

Adjust and secure arm using lever assembly **no. 13**, guide **no. 12**, outer spacer **no. 11** and spacer block **no. 10**.

Unsheathe wires from new arm and replace female terminals with new female terminals **no. 18**. Pay close attention to wire colors.



A32H23A

PAY CLOSE ATTENTION TO THE WIRE LOCATION

Close and screw cover.

Install handle grip sheath correctly.



A32H24A

Reinstall hand protectors using black rivets **no. 15**.

Reinstall rear suspension.

Reinstall seat, rear mouldings and connectors.

On each side, drill the third hole of fixation plate and complete installation with a screw **no. 20**, a lock washer **no. 21** and an elastic nut **no. 22**.

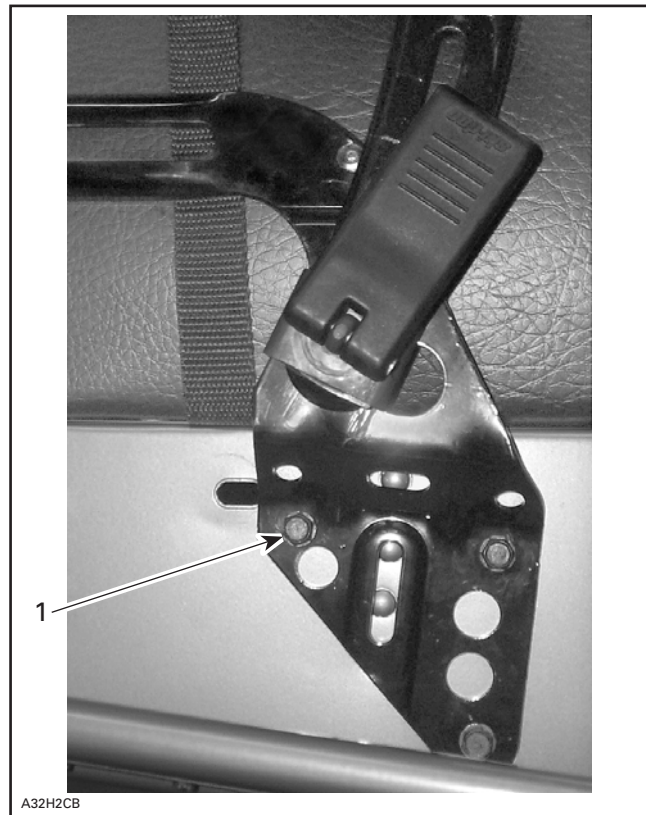

A32H2CB

1. Drill and install third screw

Check handle grip heating system.

861 776 700

1.	511 000 182	Right Hand Arm Assembly	Poignée de maintien de droite (complète)
2.	511 000 183	Left Hand Arm Assembly	Poignée de maintien de gauche (complète)
3.	517 302 497	Right Hand Retaining Plate	Plaque de fixation de la poignée de droite
4.	517 302 499	Left Hand Retaining Plate	Plaque de fixation de la poignée de gauche
5.	517 302 494	Pivot (2)	Pivot (2)
6.	205 461 846	Hexagonal Socket Head Bolt M6 x 18 (2)	Boulon à tête creuse hexagonale M6 x 18 (2)
7.	205 061 644	Hexagonal Socket Head Bolt M6 x 16 (2)	Boulon à tête creuse hexagonale M6 x 16 (2)
8.	234 062 100	Plastic Flat Washer M6 (2)	Rondelle plate de plastique M6 (2)
9.	232 561 414	Hexagonal Elastic Nut (2)	Écrou hexagonal élastique (2)
10.	572 088 900	Spacer Block (2)	Entretoise (2)
11.	570 063 800	Outer Spacer (2)	Entretoise extérieure (2)
12.	517 290 000	Guide (2)	Guide (2)
13.	580 611 000	Lever Assembly (2)	Levier (complet) (2)
14.	390 403 600	Black Rivet 3/16 in (4)	Rivet noir 3/16 po (4)
15.	390 907 700	Black Rivet 3/16 in (4)	Rivet noir 3/16 po (4)
16.	409 010 800	Male Terminal (3)	Connecteur mâle (3)
17.	409 204 200	Male Housing	Raccord mâle
18.	409 010 700	Female Terminal (3)	Connecteur femelle (3)
19.	415 050 400	Handle Grip	Poignée
20.	210 261 680	Self-Tapping Flanged Hexagonal Screw (6)	Vis à tête autotaraudeuse hexagonale à épaulement (6)
21.	234 161 601	Helicoid Lock Washer M6 (6)	Rondelle-frein hélicoïdale M6 (6)
22.	233 261 414	Elastic Flanged Nut M6 (2)	Écrou élastique à épaulement M6 (2)