



⚠ WARNING

For safety reasons, this kit must be installed by an authorized Ski-Doo® snowmobile dealer. Should removal of a locking device (e.g. lock tabs, self-locking fasteners, etc.) be required when undergoing disassembly/assembly, always replace with a new one. This instruction sheet should be given to the purchaser. This kit is designed for specific applicable models only. It is not recommended for units other than those for which it was sold.

NOTE: Installation time is approximately 0.5 hour.

PARTS TO BE INSTALLED

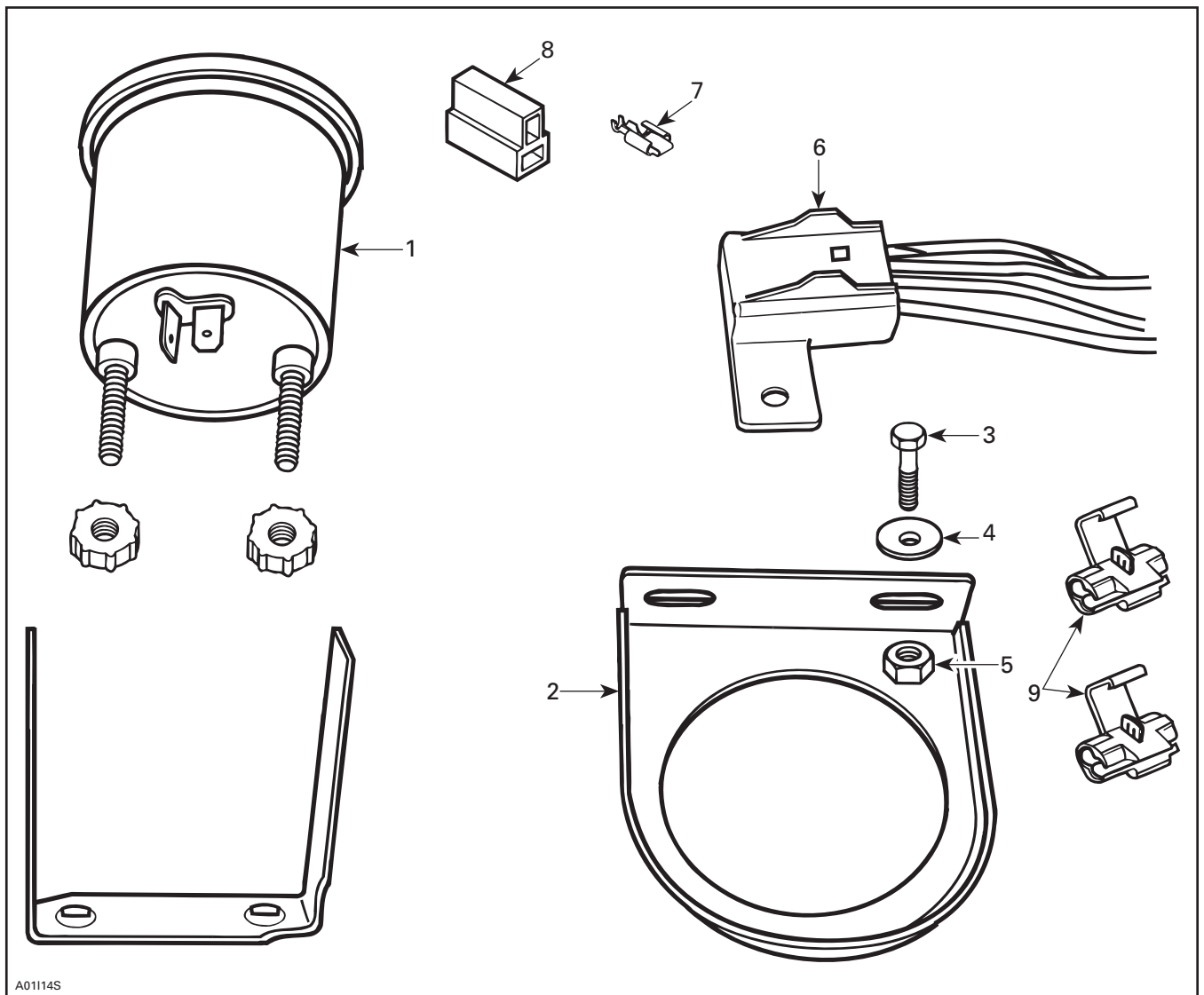

A01114S

1. Hour meter
2. Support
3. Screw M5 x 16 (2)
4. Washer M6 (2)
5. Nut M5 (2)

6. Converter
7. Connector (2)
8. 2 Connector Housing
9. Joint Connector (2)

INSTRUCTIONS

CAUTION: If applicable, disconnect the battery as per *Shop Manual*, negative ground cable **FIRST**.

NOTE: It is preferable to install the hour meter in the dashboard if there is enough space.

Dashboard Installation

Using the last page template, cut a 53 mm (2-3/32 in) hole in the dashboard. Install the gauge **no. 1** in the hole and secure with the U-bracket and nuts. You can use the free connectors near the other dashboard gauges power (YELLOW) and ground (YELLOW/BLACK) to plug the hour meter.

ANY OTHER LOCATION

Mount the hour meter **no. 1** in a suitable location using the support **no. 2** included in the kit.

Wiring

Using the joints connectors, connect the converter harness YELLOW wire to any vehicle YELLOW connector, do the same with the converter harness **no. 6** YELLOW/BLACK wire.

Install connectors at the end of the RED and the BLACK converter harness wires.

Insert in the 2 connector housing and connect to the indicator as illustrated.

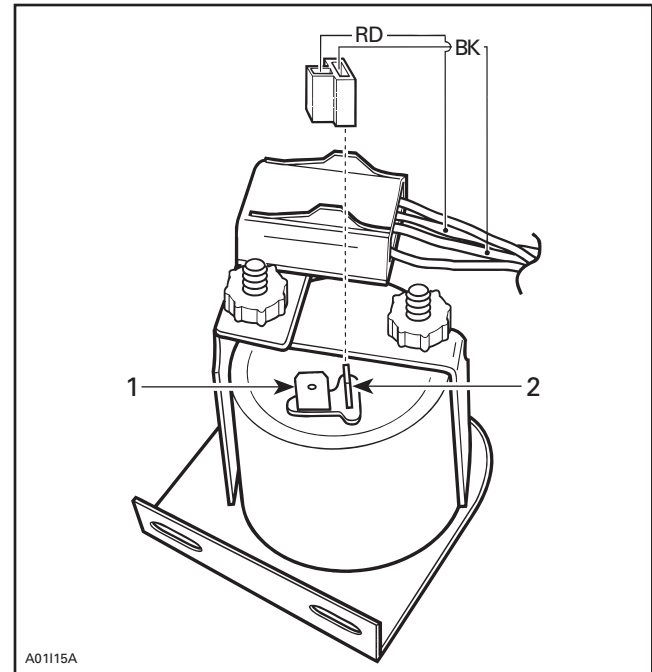

1. RED wire to positive (+)
2. BLACK wire to negative (-)

Enlarge the converter hole to 5 mm (13/64 in). Install the converter on one of the gauge studs. Secure slacked wires with a tie rap.

CAUTION: Route wires away from any rotating, heating, moving or vibrating parts. Use proper fastening devices as required. If applicable, reconnect the battery as per *Shop Manual*, negative ground last.

Start the engine and check hour meter operation.

Use this template to properly drill the dashboard gauge installation hole.

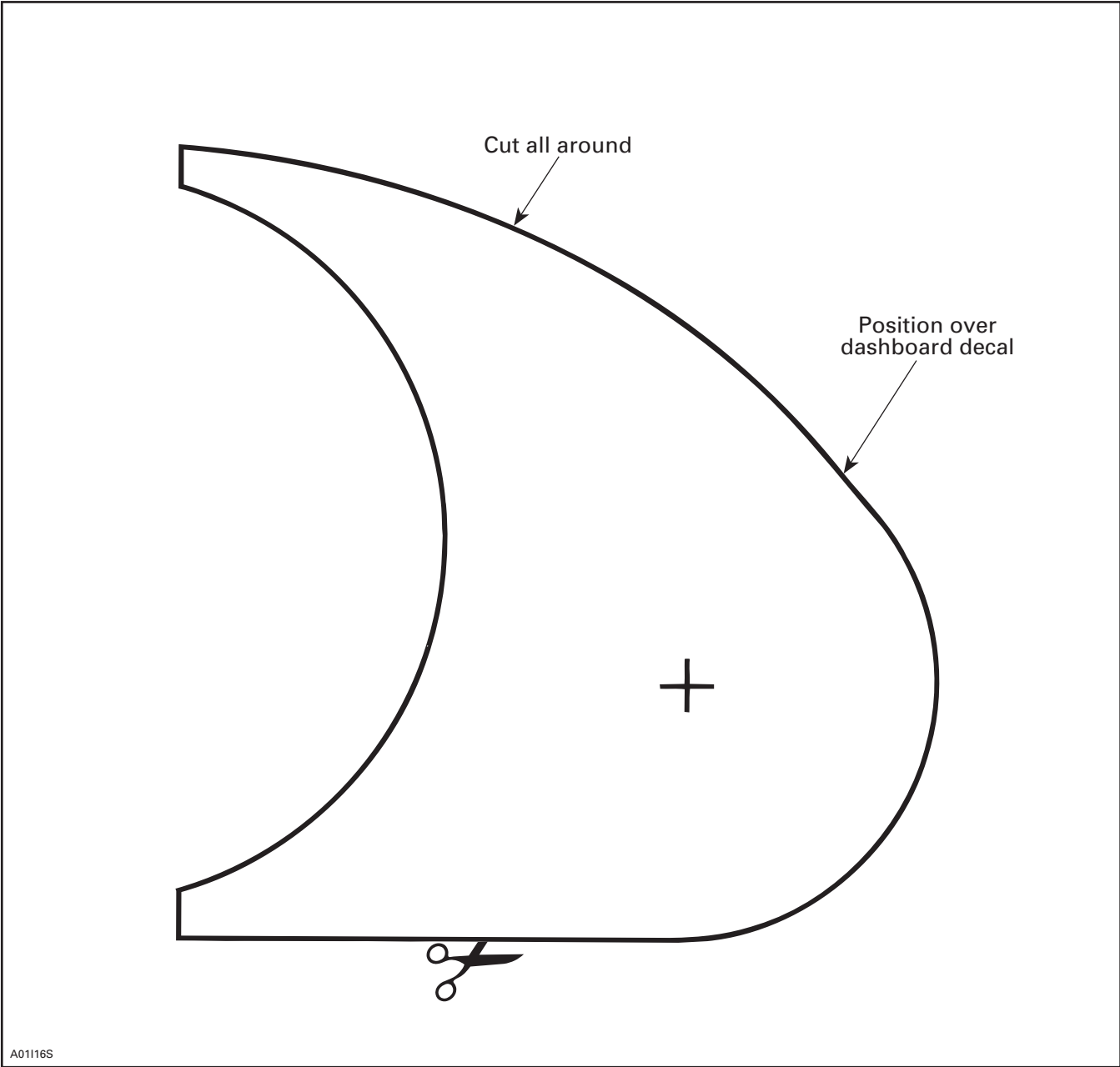

861 748 200

1.	414 989 100	Hour Meter	Totalisateur d'heures
2.	414 989 200	Support	Support
3.	207 151 644	Screw M5 x 16 (2)	Vis M5 x 16 (2)
4.	224 061 121	Washer M6 (2)	Rondelle M6 (2)
5.	233 251 414	Nut M5 (2)	Écrou M5 (2)
6.	410 919 900	Converter	Convertisseur
7.	561 503 100	Connector (2)	Raccord (2)
8.	409 204 600	2 Connector Housing	Logement à 2 raccords
9.	409 900 400	Joint Connector (2)	Cosse de raccordement (2)