



**LUGGAGE RACK
(P/N 861 772 200)**

⚠ WARNING

For safety reasons, this kit must be installed by an authorized Ski-Doo® snowmobile dealer. Should removal of a locking device (e.g. lock tabs, self-locking fasteners, etc.) be required when undergoing disassembly/assembly, always replace with a new one. This instruction sheet should be given to the purchaser. This kit is designed for specific applicable models only. It is not recommended for units other than those for which it was sold.

NOTE: Installation time is approximately 1.0 hour.

PARTS TO BE INSTALLED

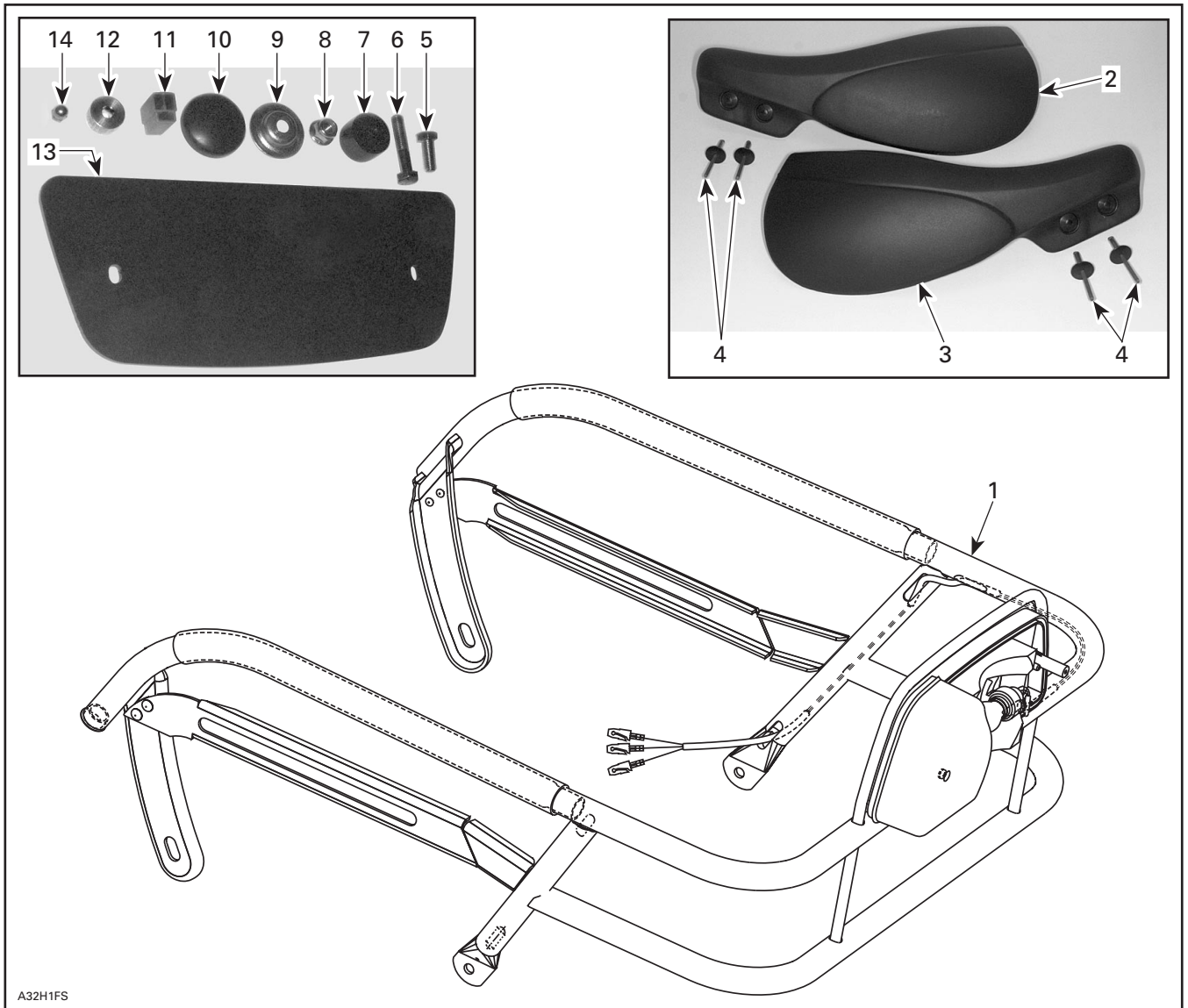

1. Luggage Rack Assembly
2. Protector (Right Side)
3. Protector (Left Side)
4. 3/16 Rivet (4)
5. M8 x 20 Hexagonal Bolt (2)
6. M8 x 40 Hexagonal Bolt (2)
7. Spacer (2)

8. M8 Flanged Elastic Nut (4)
9. Cup (2)
10. Cap (2)
11. Female Housing
12. Spacer (2)
13. Cover
14. M5 Dome Nut (2)

VEHICLE PREPARATION

Remove tail light assembly from seat.

Remove seat and moldings.

Remove tab connectors from tail light connector block.

S-Series Models

Remove staples 300 mm (1 ft) in length from right rear corner and moving forward alongside of seat.

Remove staples 140 mm (5-1/2 in) in length from rear of seat.

Drill a 25 mm (1 in) hole in bottom of seat.

Refer to the following illustration.

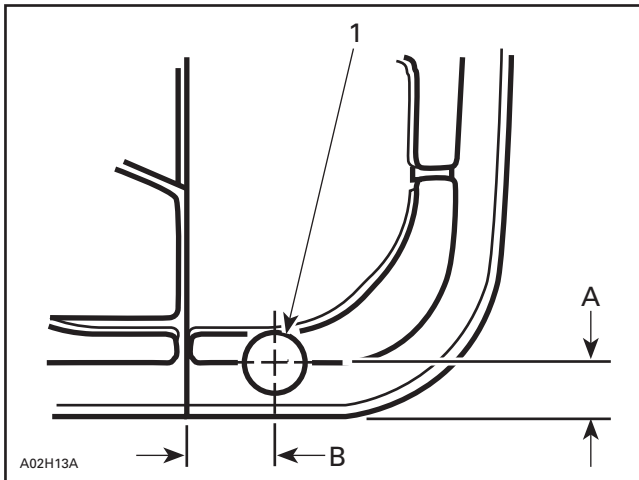

1. Drill hole here
- A. 25 mm (1 in)
- B. 30 mm (1-3/16 in)

Reroute tail light harness into previously drilled hole by passing it through foam in seat.

NOTE: Remove more staples if required for easier access.

Pull harness through hole then install female housing **no. 11**.

Restaple seat cover.

ZX Series Models

Turn seat upside down and locate existing hole in base.

Pull out wire through existing hole.

Cut and extract just enough foam to be able to pass wire connector, taking care not to cut wire.

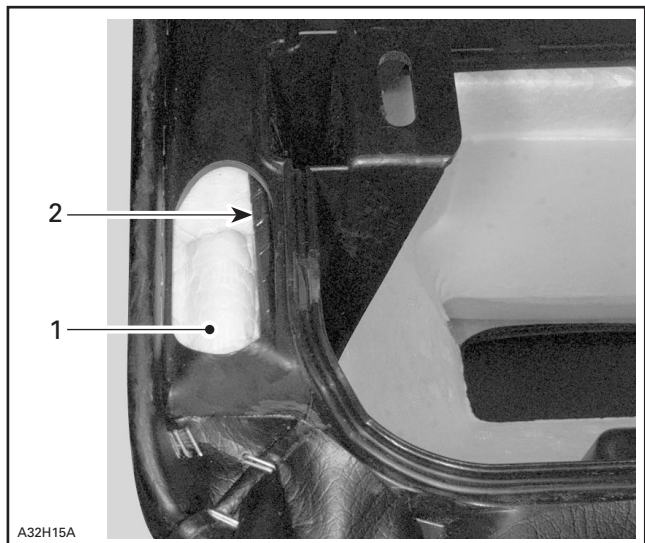

RIGHT REAR CORNER SHOWN — SEAT UPSIDE DOWN

1. Cut and remove some of this foam
2. Pull out this wire from here

Install the tab connectors as illustrated into new female housing **no. 11**.

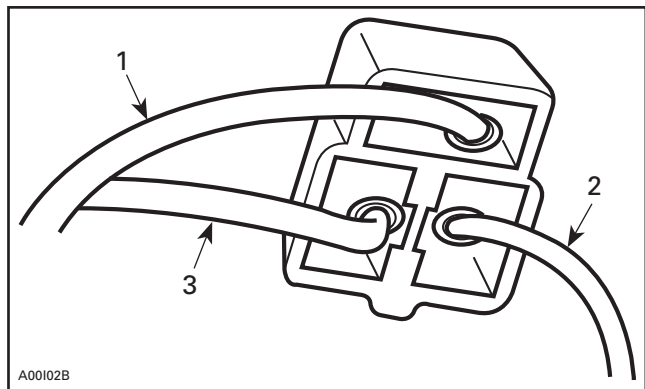

1. YELLOW/BLACK
2. YELLOW
3. WHITE

All Models

Install spacers **no. 12**, plastic cover **no. 13** and M5 dome nuts **no. 14** on seat in previous tail light location. If necessary, install washers (P/N 517 124 300), not supplied in this kit.

Luggage Rack Installation

Locate the rear hole on each side of tunnel as illustrated; if none, drill an 8.5 mm (11/32 in) hole on each side.

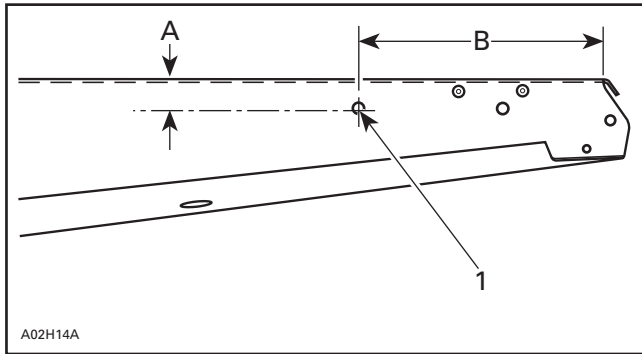

1. Rear hole 8.5 mm (11/32 in)
- A. 25 mm (1 in)
- B. 170 mm (6-51/64 in)

Using these 2 holes, install rear mounts of luggage rack assembly **no. 1** on vehicle with M8 x 20 hexagonal bolts **no. 5** and M8 flanged elastic nuts **no. 8**. Hand tighten for now.

Lean rack forward until it fits parallel to floor and drill an 8.5 mm (11/32 in) hole through tunnel as well as tunnel reinforcement on each side.

CAUTION: Use extreme caution when drilling, do not pierce heat exchangers. Use a thin block of wood as a backing plate when drilling.

S-Series Models

Plug tab connectors for the tail light and pull excess wiring toward the inside of seat through previously drilled hole.

ZX Series Models

Plug the 2 connectors beneath the seat, then place them in the seat by passing them through hole made from extracting foam. Assure to leave some slack in the wires.

All Models

Reinstall seat then secure front part of luggage rack assembly with M8 x 40 hexagonal bolts **no. 6**, cups **no. 9**, spacers **no. 7** and M8 flanged elastic nuts **no. 8**. Refer to following photo.

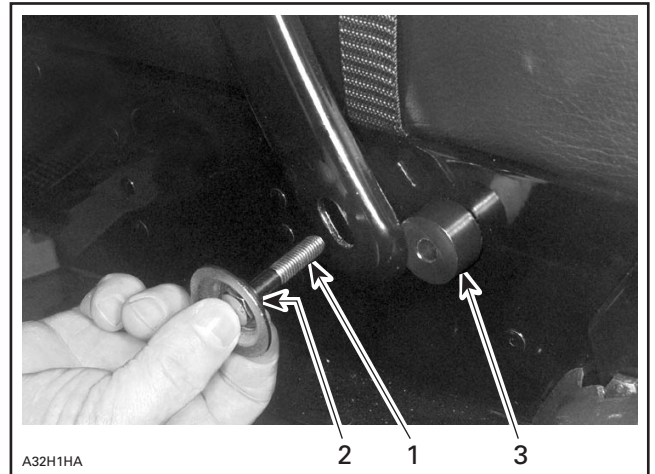

1. M8 x 40 hexagonal bolt
2. Cup
3. Spacer

On S-Series models, make sure that connectors are properly tucked into seat and that there is no gap between seat and top of tunnel.

Firmly tighten seat and luggage rack.

Snap caps **no. 10** onto cups.

Position and secure left side protector **no. 3** and right side protector **no. 2** at front of handle bar, in existing holes, using 3/16 rivets **no. 4**.

Cut moldings to fit around rack tubes.

Reinstall moldings.

Test tail light and brake light for proper operation.

861 772 200

1.	511 000 144	Luggage Rack Assembly	Porte-bagages (complet)
2.	572 089 400	Protector (Right Side)	Protecteur droit
3.	572 089 500	Protector (Left Side)	Protecteur gauche
4.	390 907 700	3/16 Rivet (4)	Rivet 3/16 (4)
5.	207 182 044	M8 x 20 Hexagonal Bolt (2)	Boulon hexagonal M8 x 20 (2)
6.	207 084 044	M8 x 40 Hexagonal Bolt (2)	Boulon hexagonal M8 x 40 (2)
7.	511 000 114	Spacer (2)	Entretoise (2)
8.	233 281 414	M8 Flanged Elastic Nut (4)	Écrou d'arrêt élastique à épaulement M8 (4)
9.	506 115 800	Cup (2)	Coupole (2)
10.	572 045 900	Cap (2)	Capuchon (2)
11.	409 204 300	Female Housing	Logement de raccord femelle
12.	517 223 600	Spacer (2)	Entretoise (2)
13.	510 003 846	Cover	Couvercle
14.	232 351 423	M5 Dome Nut (2)	Écrou-capuchon M5 (2)