



◆ WARNING

For safety reasons, this kit must be installed by an authorized Bombardier snowmobile dealer. Should removal of a locking device (e.g. lock tabs, self-locking fasteners, etc.) be required when undergoing disassembly/assembly, always replace with a new one. This instruction sheet should be given to the purchaser. This kit is designed for specific applicable models only. It is not recommended for units other than those for which it was sold.

NOTE: Installation time is approximately 1.0 hour.

PARTS TO BE INSTALLED

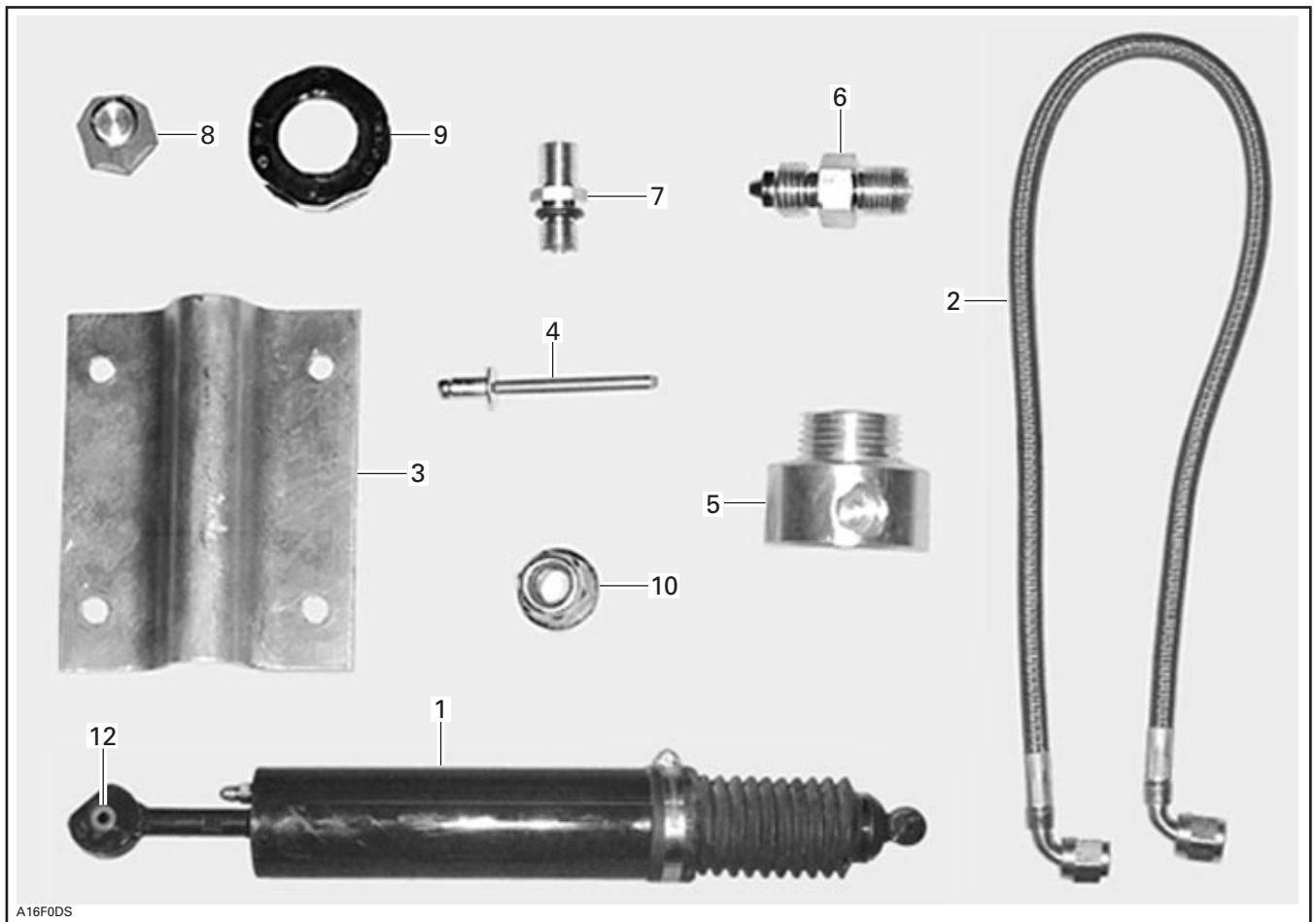

A16F0DS

- | | |
|-------------------|-----------------------------|
| 1. Shock Absorber | 7. Air Valve with O-Ring |
| 2. Pneumatic Hose | 8. Valve Cap |
| 3. Plate | 9. Assembling Nut |
| 4. Rivet (4) | 10. Elastic Lock Nut (2) |
| 5. Adaptor | 11. Decal (not illustrated) |
| 6. Connector | 12. Bushing |

PROCEDURE

Valve Preparation

Screw air valve no. 7 on adaptor no. 5. Do not use locking product.

In the other hole, screw connector no. 6. Apply Loctite 242 on threads.

Install one end of the pneumatic hose no. 2 on the connector. Torque tightly.

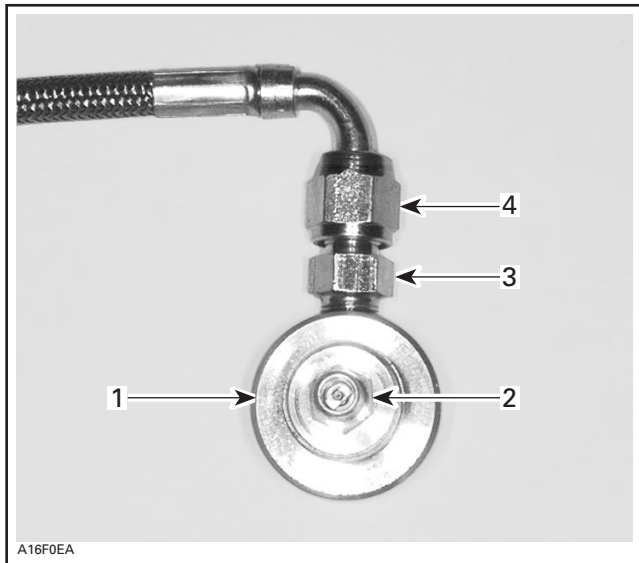

1. Adaptor
2. Air valve
3. Connector
4. Pneumatic hose

Vehicle Preparation

Uninstall rear part of rear suspension.

Remove rear shock absorber and discard elastic lock nuts. Refer to appropriate *Shop Manual* for proper procedures.

NOTE: If snowmobile is equipped with flat tie-rods, remove them and install the new tie-rods (P/N 503 184 900). The new tie-rods are not included in this kit.

Adapter Hole Drilling

S-Series Models

Using a center punch, mark a hole position centered in upper hole of rear arm support.

Drill a 18 mm (0.709 in) hole through the support.

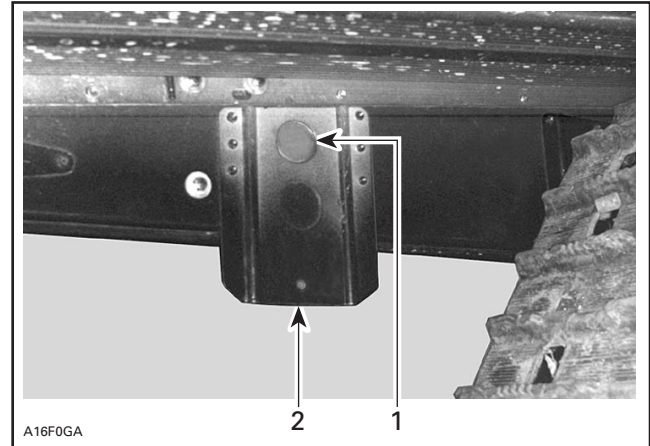

1. 18 mm (0.709 in) hole position
2. Left rear arm support

CK3 Series Models

Cut and place template no. 2 (refer to the last page). Secure with tape. See the following illustration for template position.



Using center punch, mark the hole position. Drill a 18 mm (0.709 in) hole.

All Models

Cut template no. 1 (refer to the last page). Place template under tunnel, on the left side, and secure with tape. See following illustration to place the template correctly.

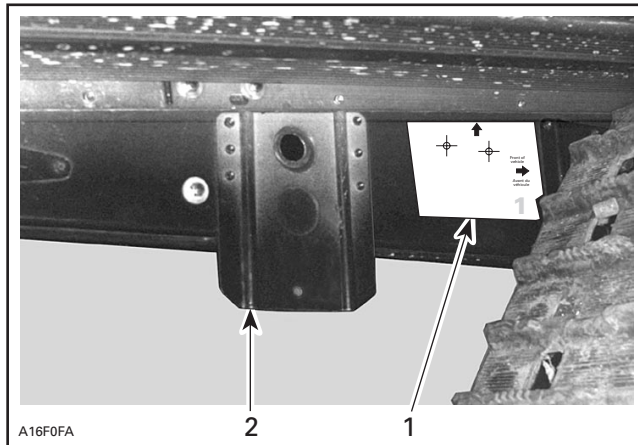

1. Template position
2. Left rear arm support

Using a center punch, mark the two hole positions. Remove the template.

Drill two 4.7 mm (3/16 in) holes.

Installation

Install decal no. 11 around hole.

Insert the adaptor in the 18 mm (0.709 in) hole and secure, by the outside, with the assembling nut no. 9.

Insert pneumatic hose in plate no. 3 and secure the plate with rivets no. 4.

NOTE: The rivets are installed by the exterior of vehicle.

Drill the other holes on bottom of the plate and secure with rivets.

Install the new shock absorber no. 1 and bushing no. 12.

Secure with the new elastic lock nuts no. 10.

Install free end of the pneumatic hose on the shock absorber connector. Torque tightly.

Reinstall the rear arm.

NOTE: Check that fitting hose doesn't interfere with track.



Add air in the shock absorber.

Check pneumatic hose, connectors and air valve for leaks. Spray a soapy water solution and look for air bubbles. Correct air leaks if any.

Install valve cap no. 8.

THIS PAGE IS PURPOSELY BLANK

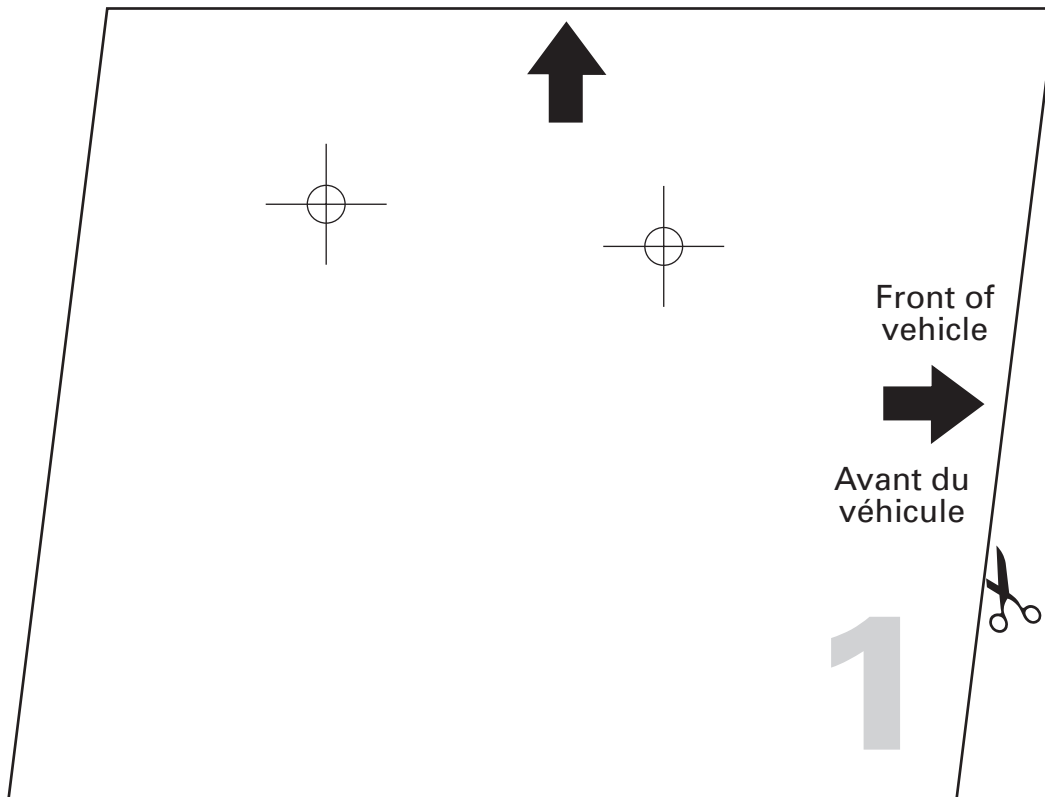
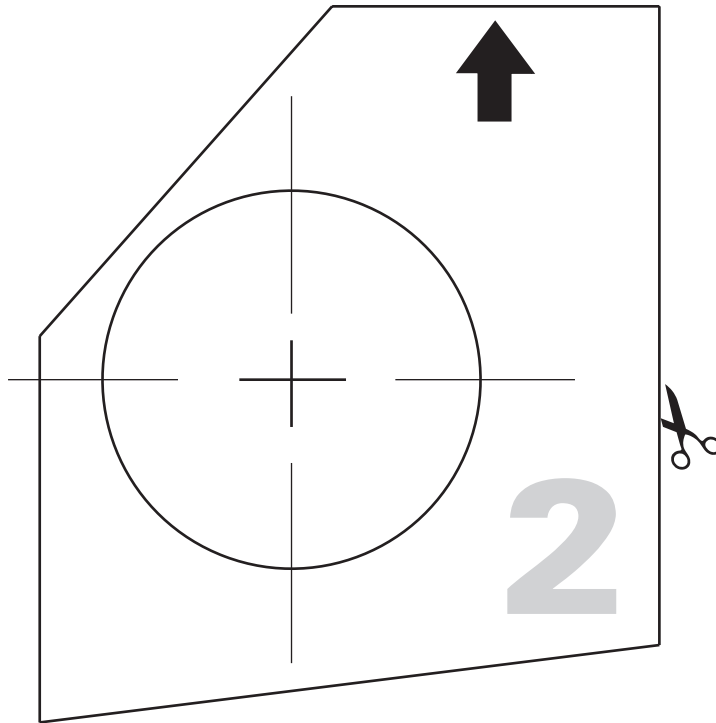

A16A01S

860 305 300

1.	503 189 409	Shock Absorber	Amortisseur
2.	503 189 407	Pneumatic Hose	Conduit pneumatique
3.	503 189 406	Plate	Plaque protectrice
4.	390 402 400	Rivet (4)	Rivet (4)
5.	414 893 900	Adaptor	Adaptateur
6.	503 189 408	Connector	Raccord
7.	414 888 314	Air Valve with O-Ring	Soupape à air avec joint torique
8.	414 888 313	Valve Cap	Capuchon
9.	414 977 200	Assembling Nut	Écrou d'assemblage
10.	232 581 414	Elastic Lock Nut (2)	Écrou d'arrêt élastique (2)
11.	415 127 720	Decal (not illustrated)	Autocollant (non illustré)
12.	414 936 000	Bushing	Douille