



◆ WARNING

For safety reasons, this kit must be installed by an authorized Bombardier snowmobile dealer. Should removal of a locking device be required when undergoing disassembly/assembly, always replace with a new one. This instruction sheet should be given to the purchaser. This kit is designed for specific applicable models only. It is not recommended for vehicles other than those for which it was sold.

NOTE: Installation time is approximately 1.0 hour.

PARTS TO BE INSTALLED

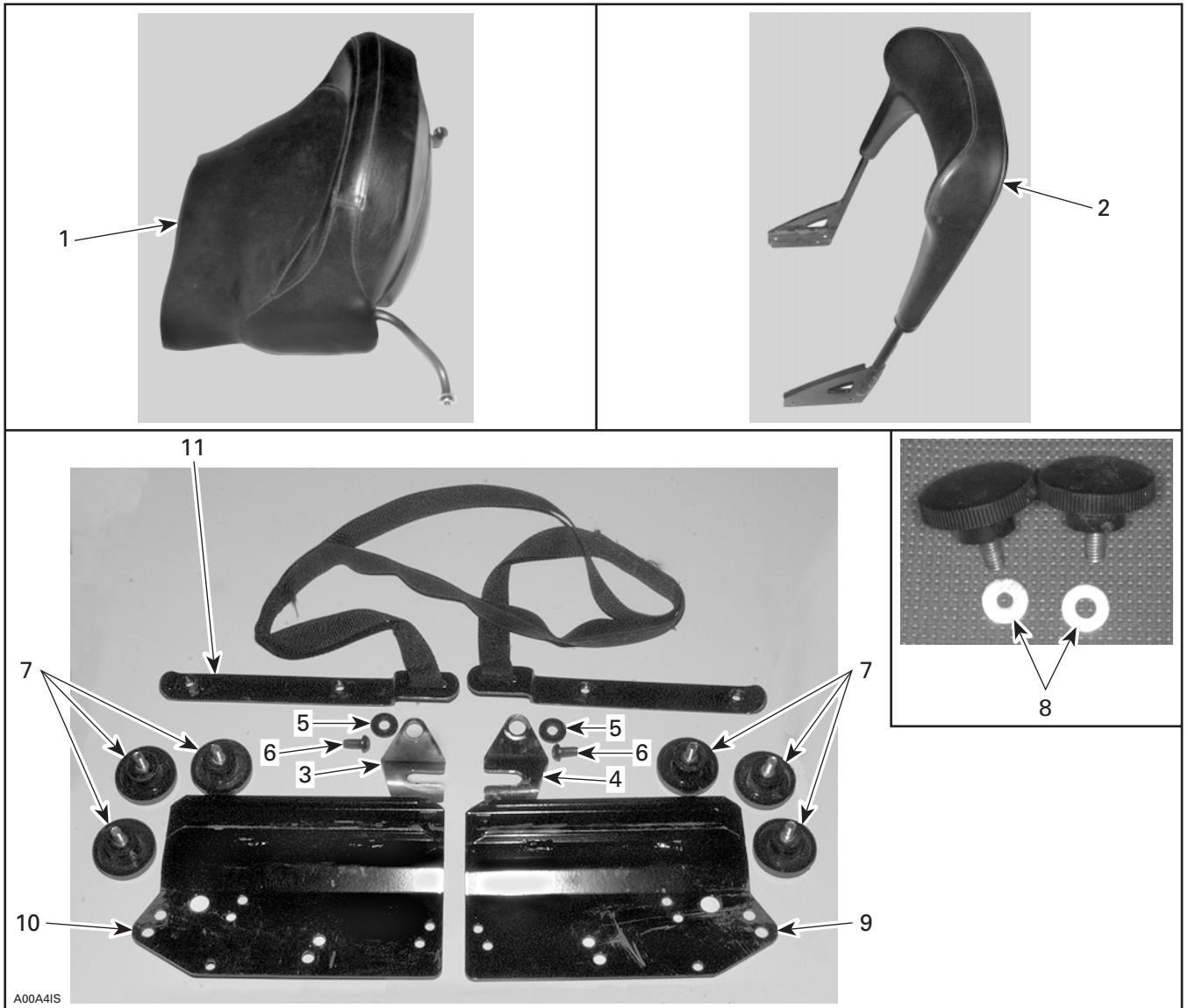

A00A4IS

1. Seat Assembly
2. Back Rest
3. Seat Bracket LH
4. Seat Bracket RH
5. Black Washer (6)
6. Taptite Screw HD Torx M8 x 16 (2)

7. Adjustable Knob (6)
8. Flat Washer (2)
9. Rail LH
10. Rail RH
11. Sliding Plate

INSTRUCTIONS

Remove moldings.

Remove rear bumper bolts.

Insert left rail **no. 9** and right rail **no. 10** between chassis and rear bumper.

Align holes so it is possible to see through molding holes.

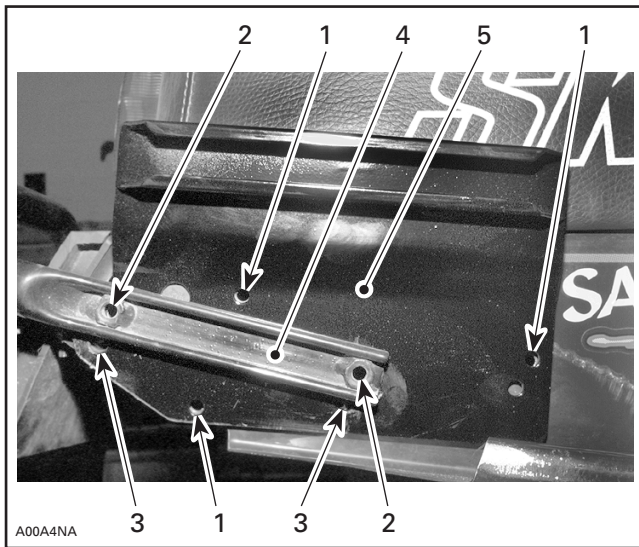

RIGHT SIDE SHOWN

1. Molding holes
2. Upper holes
3. Lower holes
4. Rear bumper
5. Rail

S-Series Models

Use upper rail holes for bumper repositioning.

CK3 Series Models

Use lower rail holes for bumper repositioning.

Secure, using previously removed bumper bolts.

CK3 Series Models

Reinstall moldings.

S-Series Models

Out moldings to fit as per following illustration.

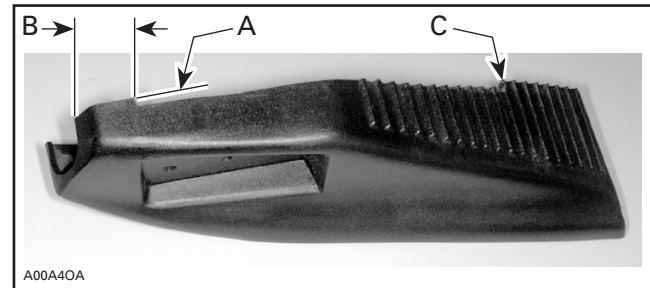

- A. 5 mm (3/16 in)
- B. 39 mm (1-9/16 in)
- C. 8th tip from front

Reinstall moldings.

Using taptite screws **no. 6** and black washers **no. 5**, secure right seat bracket **no. 4** and left seat bracket **no. 3** onto seat **no. 1** pivot rods, then install on back rest **no. 2** securing both sides with adjustable knobs **no. 7** (one on each side) and washers **no. 8**.

Insert plates **no. 11** in rails, on each side, making sure stretched section of strap is at bottom position.

Align back rest onto rails, each side, with previously inserted plates so that adjustable knobs **no. 7**, two on each side, reach plate holes. Install these adjustable knobs with black washers **no. 5**.

Pull strap upward onto seat.

Verify operation of movable parts.

Note that it is possible to fit Grab Handle Kit (P/N 861 765 300) to the present kit but it would require removal of all four (4) sliding adjustable knob black washers **no. 5**.

861 769 300

1.	510 003 653	Seat Assembly	Siège (complet)
2.	415 124 200	Back Rest	Dossier
3.	517 299 900	Seat Bracket LH	Support de siège (gauche)
4.	517 300 000	Seat Bracket RH	Support de siège (droit)
5.	503 169 900	Black Washer (6)	Rondelle noire (6)
6.	732 601 246	Taptite Screw HD Torx M8 x 16 (2)	Vis autotaraudeuse torx M8 x 16 (2)
7.	415 124 300	Adjustable Knob (6)	Bouton de réglage (6)
8.	224 081 201	Flat Washer (2)	Rondelle plate (2)
9.	517 300 100	Rail LH	Rail (gauche)
10.	517 300 200	Rail RH	Rail (droit)
11.	510 003 654	Sliding Plate	Plaque coulissante