



◆ **WARNING**

For safety reasons, this kit must be installed by an authorized Bombardier snowmobile dealer. Should removal of a locking device be required when undergoing disassembly/assembly, always replace with a new one. This instruction sheet should be given to the purchaser. This kit is designed for specific applicable models only. It is not recommended for vehicles other than those for which it was sold.

NOTE: Installation time is approximately 0.5 hour.

PARTS TO BE INSTALLED

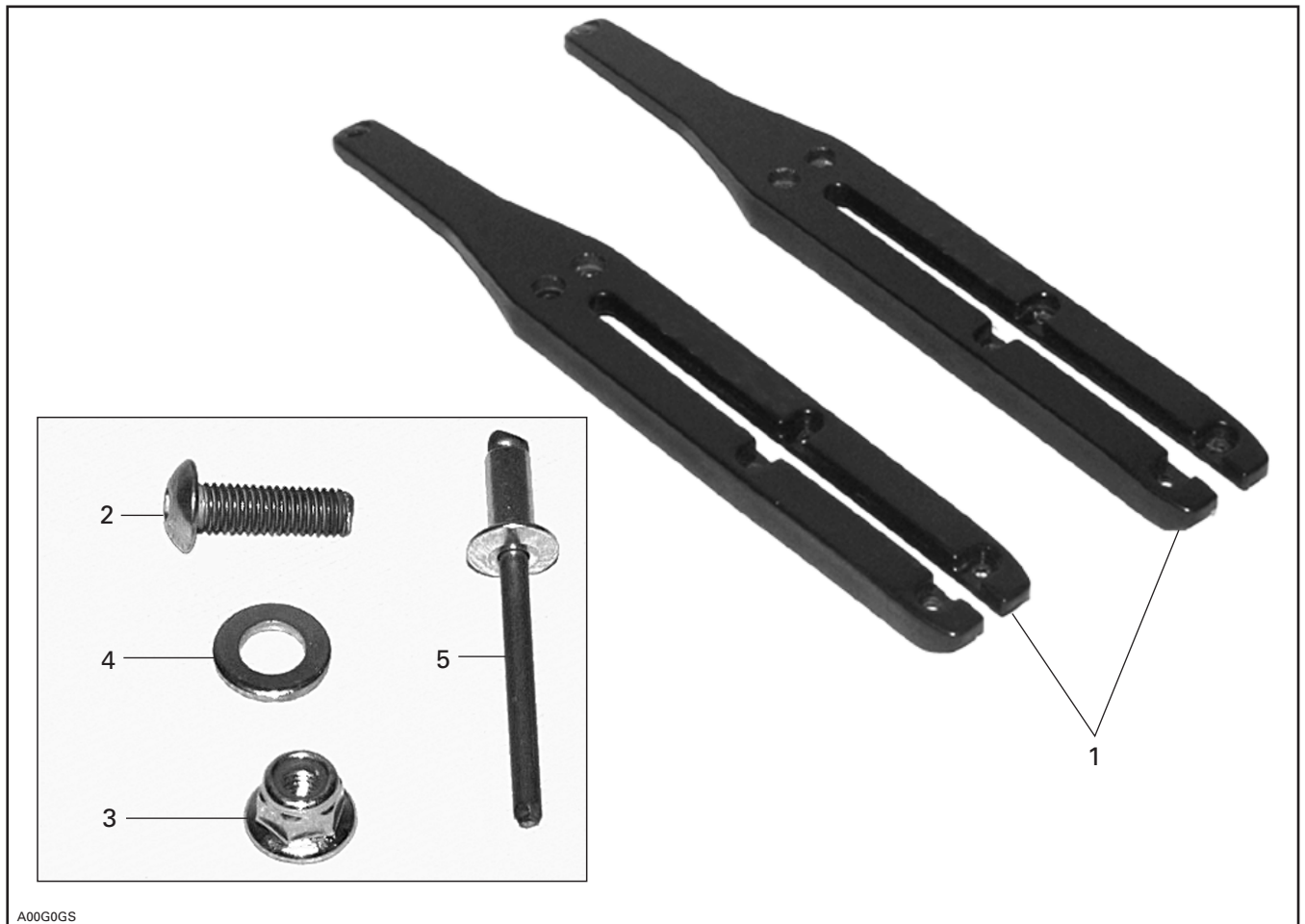

- 1. Proactive Control (2)
- 2. Screw M5 x 16 (2)
- 3. Flanged Elastic Nut M5 (2)

- 4. Flat Washer (2)
- 5. Rivet (12)

SKI REMOVAL

Lift front of vehicle.

Remove skis from vehicle.

PROACTIVE CONTROLS INSTALLATION

Turn ski over and place in a bench vise.

Position proactive control **no. 1** onto ski.

NOTE: Align proactive control slot with ski runner slot, as shown in the following photo.

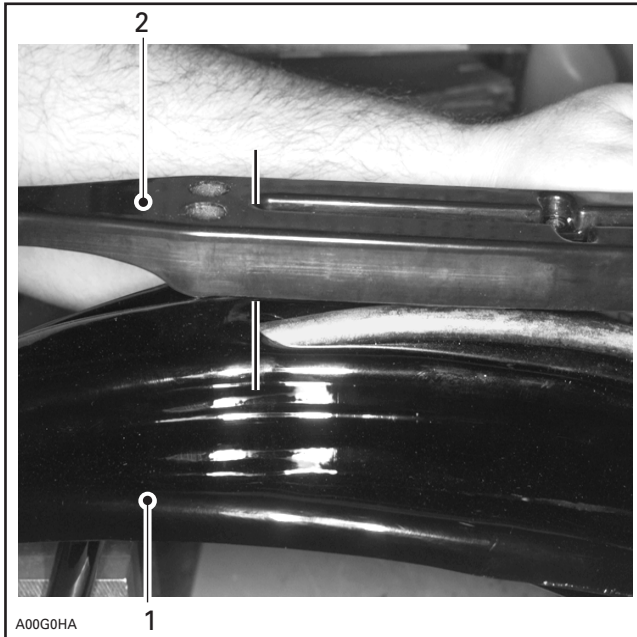

1. Ski surface
2. Proactive control

Using a center punch, mark the 2 hole positions, as shown.

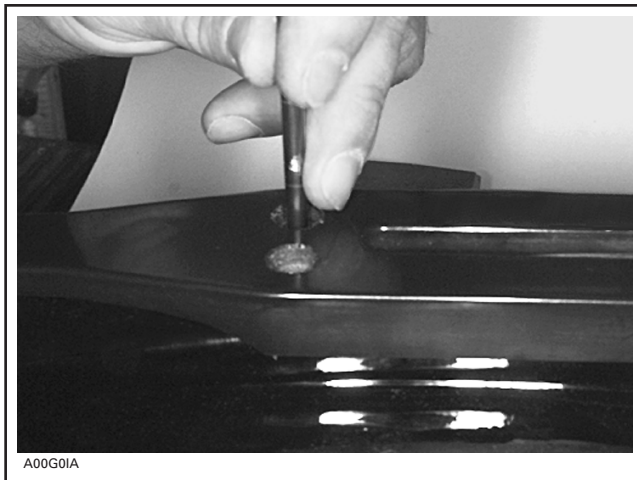

Temporarily remove proactive control and drill 5 mm (13/64 in) holes, as shown.



Reinstall proactive control.

Secure with rivets **no. 5**.

Continue proactive control installation using the following sequence.

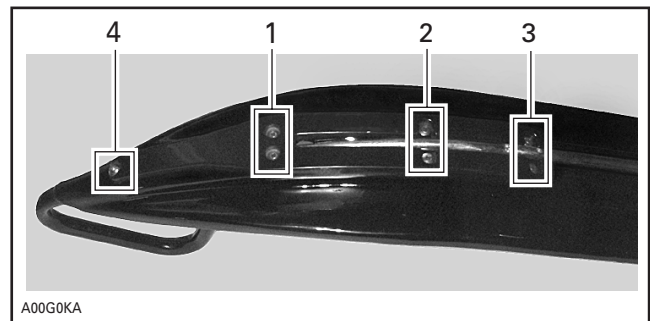

INSTALLATION SEQUENCE

NOTE: When performing steps 2 and 3 of the installation sequence, use clamp pliers to hold proactive control in place. Refer to the following photo.



FINALIZING PROACTIVE CONTROL INSTALLATION (STEP 4)

Secure with screw **no. 2**, flat washer **no. 4** and flanged elastic nut **no. 3**, as shown on the next photo.

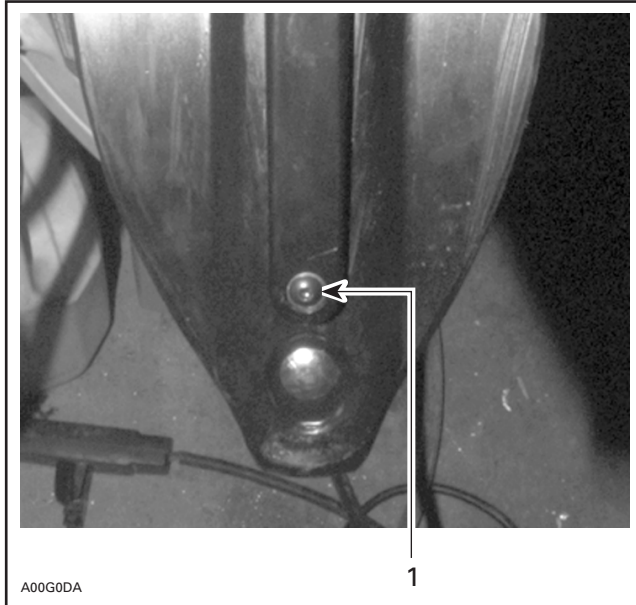

TYPICAL

1. Flat washer on this side and flanged elastic nut on the other side

Repeat procedure for the other ski.

SKI INSTALLATION

Reinstall both skis on vehicle.

Torque to 40 N•m (30 lbf•ft).

860 501 300

| | | | |
|----|-------------|----------------------------|-------------------------------------|
| 1. | 505 070 087 | Proactive Control (2) | Contrôle proactif (2) |
| 2. | 205 451 646 | Screw M5 x 16 (2) | Vis M5 x 16 (2) |
| 3. | 233 251 414 | Flanged Elastic Nut M5 (2) | Écrou à épaulement élastique M5 (2) |
| 4. | 234 061 410 | Flat Washer (2) | Rondelle plate (2) |
| 5. | 390 402 200 | Rivet (12) | Rivet (12) |