



◆ WARNING

For safety reasons, this kit must be installed by an authorized Bombardier snowmobile dealer. Should removal of a locking device be required when undergoing disassembly/assembly, always replace with a new one. This instruction sheet should be given to the purchaser. This kit is designed for specific applicable models only. It is not recommended for vehicles other than those for which it was sold.

NOTE: Installation time is approximately 1.1 hour.

PARTS TO BE INSTALLED

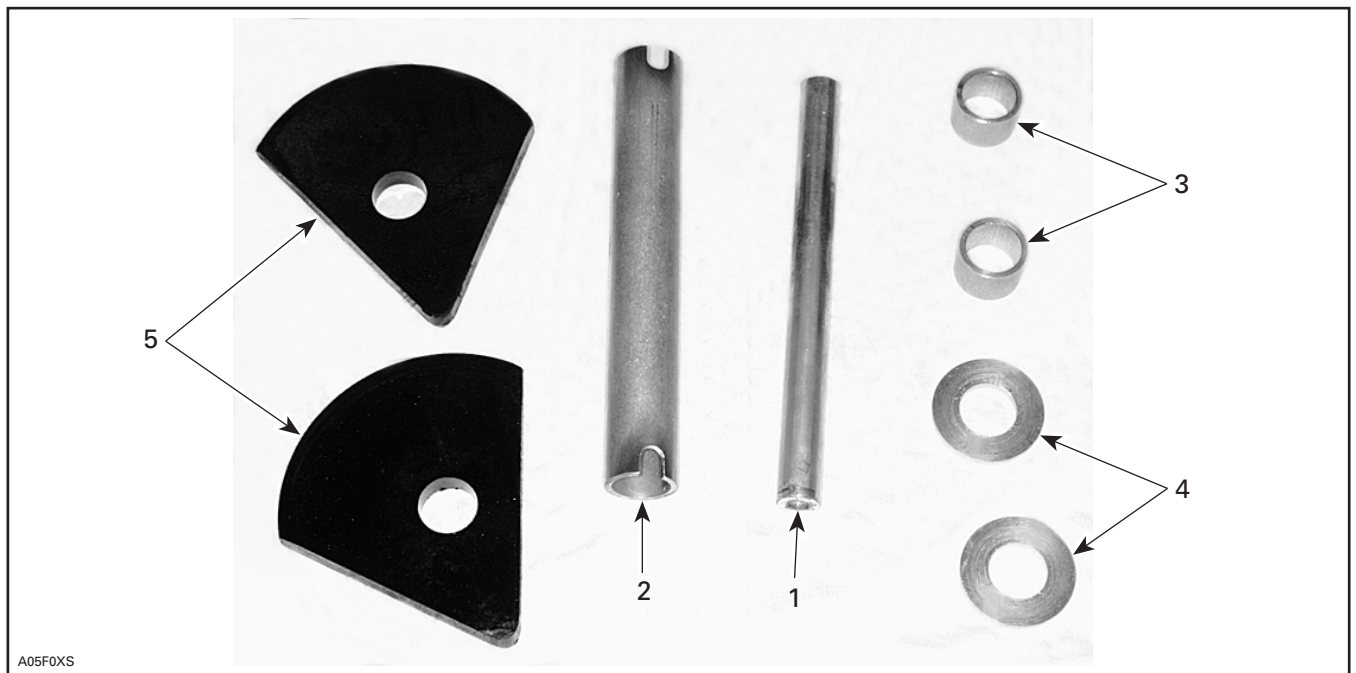

1. Cross Shaft
2. Inner Spacer
3. Outer Spacer (2)
4. Flat Washer (2)
5. Guide (2)

INSTRUCTION

Remove rear suspension assembly, refer to the *1998 Shop Manual, volume 1*, (P/N 484 068 000), for proper procedure.

Lay rear suspension assembly on a work bench.

Dismantle all components in order to reverse rail/slider shoe positioning, left to right, right to left.

Reverse positioning and reinstall all components (reversing removal procedure), using Loctite 271 (red), (P/N 413 707 400), on bolt threads.

Reinstallation is reversing removal procedure with the following exceptions:

- Cross shaft is replaced by **no. 1**, 10 mm (3/8 in) shorter than original.
- Rear axle is mounted in a new inner spacer **no. 2**, new outer spacers **no. 3**, with guides **no. 5** and flat washers **no. 4**.
- Discarded original parts are cross shaft, rear axle inner spacer, 2 outer spacers and 2 outside flat washers .

Note that guides **no. 5** are mounted with round edge toward rear and that they are properly seated on slider shoes.

Ensure existing inside flat washer is properly installed on each side, as shown in following photo.

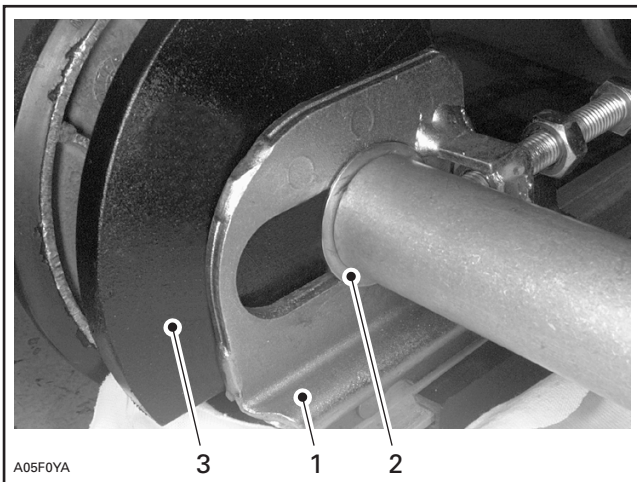

LEFT SIDE SHOWN

1. Adjustment Plate
2. Inside Flat Washer
3. Guide

Ensure support screws are removed and reinstalled heads out. Refer to following photo.

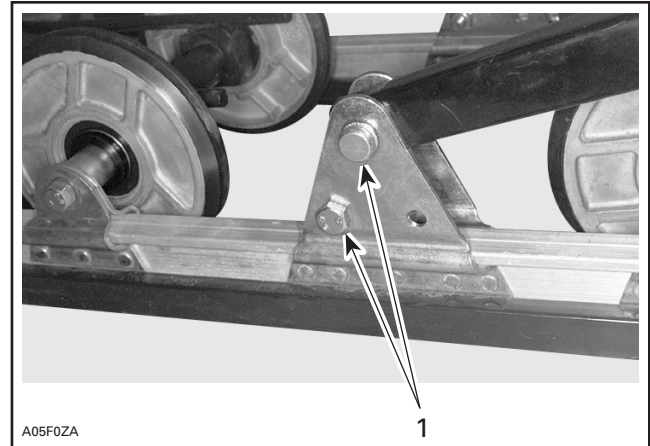

1. Heads Out

Where cotter pins are removed, ensure to secure with **new ones**, refer to following photo.

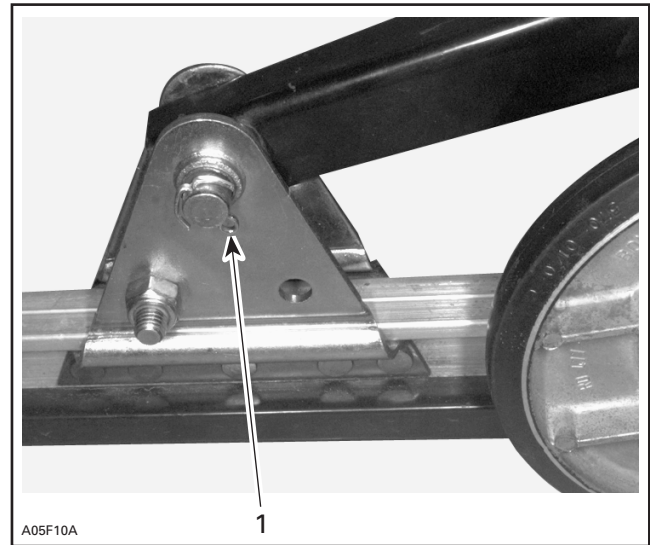

1. Renew Cotter Pin

Reinstall rear suspension assembly, using Loctite 271 (red), (P/N 413 707 400), on bolt threads.

861 770 500

1.	503 189 225	Cross Shaft	Arbre transversal
2.	503 189 238	Inner Spacer	Entretoise intérieure
3.	503 189 237	Outer Spacer (2)	Entretoise extérieure (2)
4.	503 189 235	Flat Washer (2)	Rondelle plate (2)
5.	503 189 236	Guide (2)	Guide (2)